



# PK 711 • 712 • 713 • 715 • 716

COVE / CABINET / SHOWCASE / DISPLAY  
LED SLIM DISK SERIES

Type	
Project	
Catalog No.	



## SPECIFICATIONS

Beam Angle	38°
Input Voltage *	24V DC
Lamp Life	50,000 hours
Operating Temp †	5°F to 104°F
Housing	Aluminum
Finish	Brushed Aluminum (Standard)
Mounting ‡	Recess or Surface Mount
Environment	Dry, Indoor
Warranty	5 Years – see published warranty terms for detailed information.

\* The included 24V DC 350mA in-line LED driver allows the use of a 24V DC power supply. The in-line LED driver is not a power supply. See Wiring Diagrams for more information.

† Exceeding the operating temperature values may damage the LEDs by reducing the lifespan, lumen output, and/or adversely impact color consistency. It is recommended adequate airflow and heat sinking be taken into consideration in the installation and application of this product. Improper thermal management may lead to premature product failure and void the warranty.

‡ Surface mount housing sold separately.

## LUMEN DATA

Part Number	Watts	Color Temp	Lumens	Efficacy (lm/W)
PK711 PK712 PK713	4.2	3000K	122	29
		4000K	138	33
		6500K	190	45
PK715 PK716	8.4	3000K	225	27
		4000K	255	30
		6500K	367	44

## FEATURES

- High power 1W LEDs
- Low profile
- 0-10V dimmable
- PK711, PK716, feature 20 deg adjustment.
- Included in-line constant current driver ensures each fixture will have the same illumination
- Includes 59" lead wire with PB connector

## DIMENSIONS

Part Number	Dimensions	Trim	Cut-Out	Adjustable
PK711LED	3-1/8"Ø x 1-1/8"H	1/8"H	2-7/8"Ø	20°
PK712LED	3"L x 3"W x 1-1/8"H	1/8"H	2-5/8"Ø	No
PK713LED	3"Ø x 1-1/8"H	1/8"H	2-3/8"Ø	No
PK715LED	4-1/8"Ø x 1-1/4"H	1/8"H	4"Ø	No
PK716LED	5"Ø x 1-5/8"H	3/16"H	4-3/8"Ø	20°

## ORDERING INSTRUCTIONS

MODEL	BEAM ANGLE	COLOR TEMP	FINISH
<input type="text"/>	<input type="text"/>	<input type="text"/>	BA : Brushed Aluminum
PK711LED	38	30 : 3000K	
PK712LED	15 *	40 : 4000K	
PK713LED	60 *	65 : 6500K	
PK715LED			
PK716LED			

\* Custom options. Consult factory for availability.

Example : PK711LED-38-30-BA



PK 711 • 712 • 713 • 715 • 716

COVE / CABINET / SHOWCASE / DISPLAY  
LED SLIM DISK SERIES

Type	
Project	
Catalog No.	

**WIRING DIAGRAMS** – For reference purposes only. Not for installation. Not to scale.

**EASY INSTALLATION - Plug and Play Dim/Non-Dim**

Parallel Port P+P

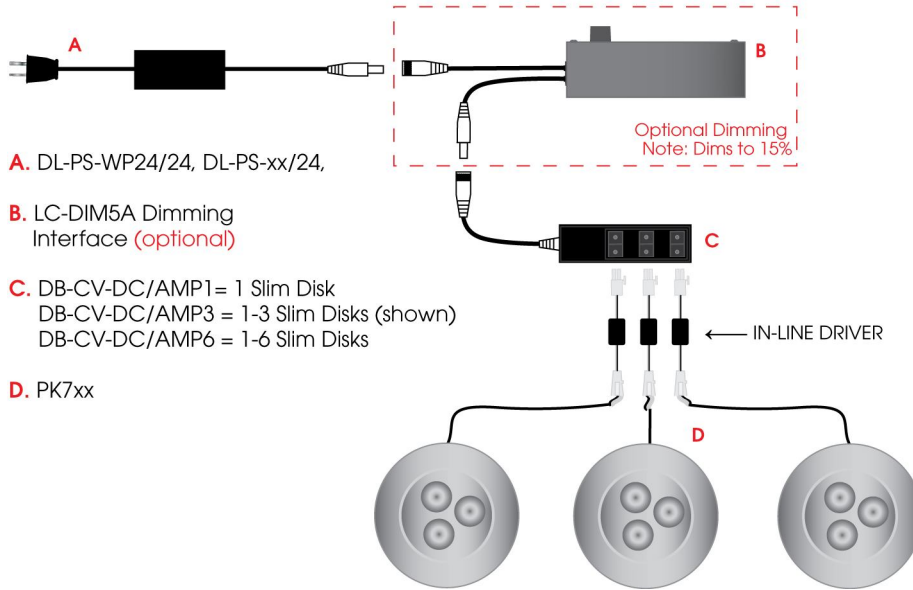

**HARD WIRE - New Construction Dim/Non-Dim**

Parallel Port HW

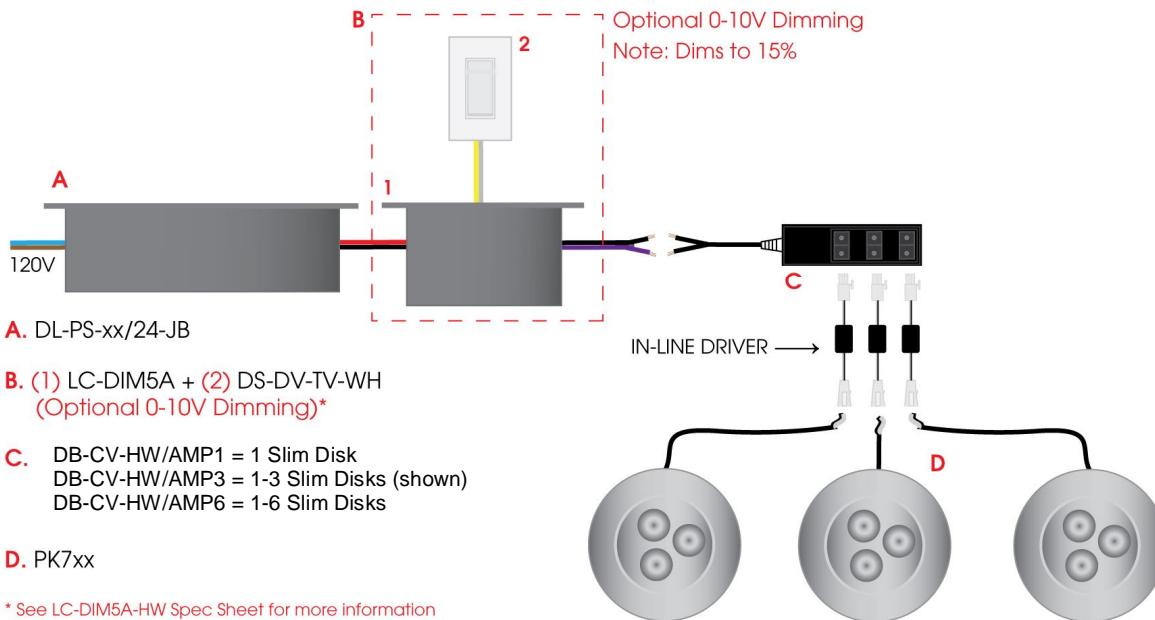



**PK 711 • 712 • 713 • 715 • 716**

**COVE / CABINET / SHOWCASE / DISPLAY**  
LED SLIM DISK SERIES

Type	
Project	
Catalog No.	

**POWER SUPPLIES – See Specification Sheets for more information.**

**Wattage** = Max power capacity of power supply. May need to be de-rated if operating at max temperature.

**Max Load** = Fixture quantity a power supply can power. It is determined by the output current of the power supply and amperage required by each fixture (350mA).

Hard-Wire Power Supplies Wet, Damp, or Dry Location UL Listed (with Junction Box)		PK711, PK712, PK713 PK715, PK716
		0.350 A
Model Number	Output Current	Max Load
DL-PS - 80 / 24 - JB - OD	3.4 A	9 fixtures
DL-PS - 96 / 24 - JB - OD	4.17 A	11 fixtures

Hard-Wire Power Supplies Dry Location UL Recognized (with Junction Box)		PK711, PK712, PK713 PK715, PK716
		0.350 A
Model Number	Output Current	Max Load
DL-PS - 20 / 24 - JB	0.83 A	2 fixtures
DL-PS - 35 / 24 - JB	1.45 A	4 fixtures
DL-PS - 60 / 24 - JB	2.50 A	7 fixtures
DL-PS - 60 / 24 - JBS	2.50 A	7 fixtures
DL-PS - 100 / 24 - JB	4.17 A	11 fixtures
DL-PS - 120 / 24 - JB *	2 x 2.5 A	2 x 7 fixtures
DL-PS - 180 / 24 - JB *	3 x 2.5 A	3 x 7 fixtures
DL-PS - 200 / 24 - JB *	2 x 4.17 A	2 x 11 fixtures

Plug & Play Power Supplies Dry Location UL Listed		PK711, PK712, PK713 PK715, PK716
		0.350 A
Model Number	Output Current	Max Load
DL-PS - WP 24 / 24	1.0 A	2 fixtures
DL-PS - 24 / 24	1.0 A	2 fixtures
DL-PS - 48 / 24	2.0 A	5 fixtures
DL-PS - 60 / 24	2.5 A	7 fixtures
DL-PS - 100 / 24	3.75 A	10 fixtures

**DIMMERS – See Specification Sheets for more information.**

**Plug and Play**

Part Number	Description
LC-DIM5A	12 / 24V, 0-10V Dimmer Built-in rotary switch
LC-DIM100-RF	12 / 24V, Step Dimmer Remote control

**Hard Wire**

Part Number	Description
LC-DIM5A-HW	12 / 24V, 0-10V Dimming Interface Requires separate 0-10V dimmer switch
LC-DIM100-RF-HW	12 / 24V, Step Dimmer Remote control
DS-DV-TV-HW	0-10V Wall Plate Dimmer Switch Smooth dimming, used with LC-DIM5A-HW



PK 711 • 712 • 713 • 715 • 716

COVE / CABINET / SHOWCASE / DISPLAY  
LED SLIM DISK SERIES

Type	
Project	
Catalog No.	

**PLUG & PLAY ACCESSORIES**

	Part Number	Description
	DB-CV-DC/AMP1	1-Port Distribution Block Connects plug and play power supply to fixture.
	DB-CV-DC/AMP3	3-Port Distribution Block Connects plug and play power supply to 3 fixtures.

	Part Number	Description
	DB-CV-DC/AMP6	6-Port Distribution Block Connects plug and play power supply to 6 fixtures.

**HARD WIRE ACCESSORIES**

	Part Number	Description
	DB-CV-HW/AMP1	1-Port Distribution Block Connects hard wire power supply to fixture.
	DB-CV-HW/AMP3	3-Port Distribution Block Connects hard wire power supply to 3 fixtures.

	Part Number	Description
	DB-CV-HW/AMP6	6-Port Distribution Block Connects hard wire power supply to 6 fixtures.

**HOUSING RING FOR SURFACE MOUNTING**



Aluminum Housing for surface mount.

Part Number	Dimensions	Slim Disk Compatibility
PKH600A	3-1/8"Ø x 1"H	PK711LED
PKH600B	3"Ø x 1"H	PK712LED
PKH600C	2-7/8"Ø x 13/16"H	PK713LED
PKH600D	4-1/2"Ø x 1-1/2"H	PK715LED
PKH600E	5"Ø x 1-3/8"H	PK716LED